

Cord Blood Collection During a C-Section

1. The cord blood collection bag should not be directly dropped onto the sterile surgical field.
2. A sterile adaptor is used during C-section collections
3. The sterile adaptor comes in a peel pack and can be dropped directly onto the sterile field

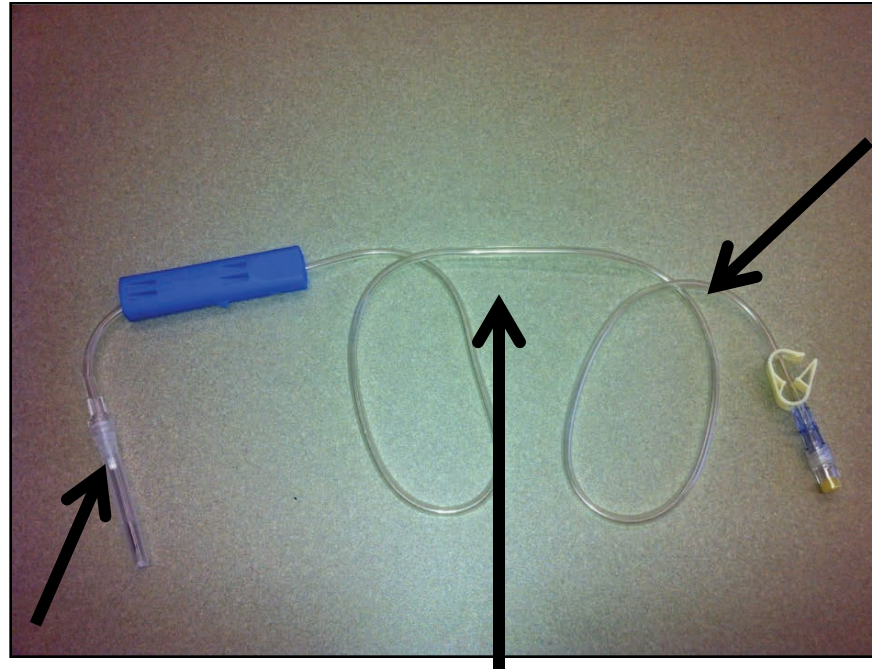

The non-sterile end is held by the circulating nurse.



The needle end remains on the sterile field, which the surgeon uses to puncture the umbilical vein

The tubing of the sterile adaptor is draped off the sterile field (similar to the suction tubing or cautery cord)

Cord Blood Collection During a C-Section

1. The circulating nurse prepares the cord blood collection bag in the usual fashion

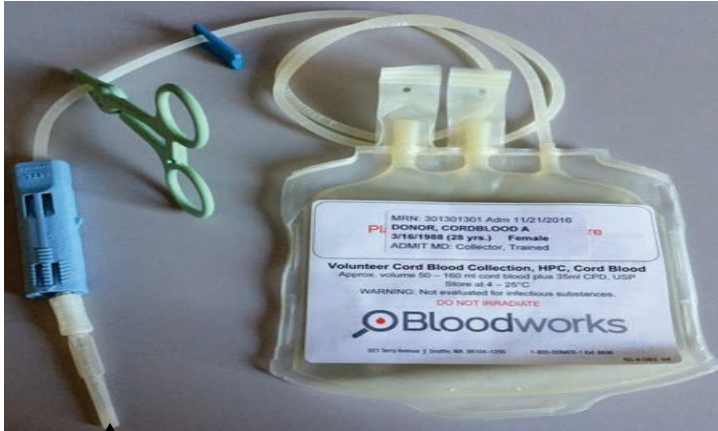

2. The needle from the collection bag is connected to the female port on the C-section adaptor

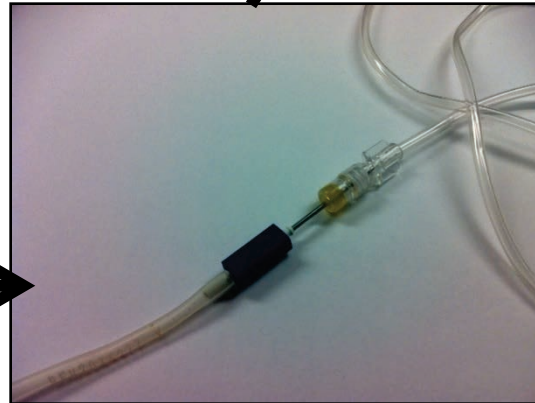

3. Once the needle is connected, the circulating nurse releases the hemostat clamp from the tubing.
4. Blood should start flowing into the collection bag.
5. The circulating nurse should gently agitate the collection bag to evenly mix the anticoagulant.
6. When collection is complete, slide closed the blue clamp near the needle to prevent air from entering the bag.
7. Slide the needle safety device over the adaptor needle. Ensure the needle guard locks into place.
8. Remove the sterile adaptor from the collection bag needle.
9. Slide the needle safety device over the collection bag needle.
10. Dispose of the adaptor into a biohazard sharps container.